

FRONT VIEW

RECOMMENDED P.C.B. LAYOUT
 (COMPONENT SIDE OF BOARD)
 TOLERANCE: ±0.05mm

NOTES:

- MATERIALS:
 HOUSING: HIGH TEMPERATURE PLASTIC, OR PBT FLAMMABILITY UL94V-0.
 CONTACTS: COPPER ALLOY.
 PLATING: GOLD ON MATING AREA (SEE AMPHENOL PART NO. OPTION).
 MATTE TIN OR GOLD FLASH ON CONTACT TAILS.
 NICKEL UNDERPLATE.

SHELL: COPPER ALLOY, NICKEL.

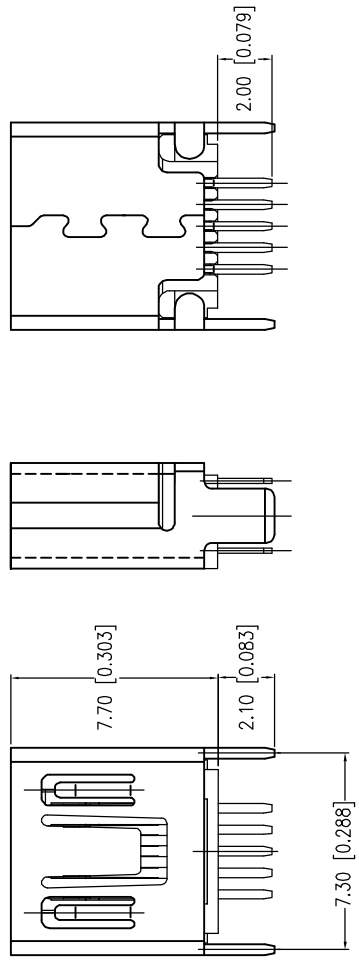

TOP VIEW

SIDE VIEW

BOTTOM VIEW

AMPHENOL PART NO.: U E 2 5 - B E X 5 - 1 0 X
 SERIES UE25=MINI USB RECEPTACLE
 TYPE B-SERIES B
 STYLE E=TOP ENTRY
 CONTACT PLATING 5=30µ" [0.76 MICRONS] GOLD PLATING ON CONTACT MATING AREA 7=GOLD FLASH OVER NICKEL ON CONTACT MATING AREA.
 MODIFIER 0=PBT H=HIGH TEMP MATERIAL (<260°C)
 SHIELD OPTIONS 0=WITHOUT REAR SHELL
 COLOUR 1=BLACK
 NUMBER OF CONTACTS 5=5 CONTACTS

UNLESS OTHERWISE SPECIFIED TOLERANCES ARE ±0.30mm		DRAWN HUILAN WANG DESIGNED MT CHEN CHECKED L. CHAN I. E. APPR. Q. A. APPR. DNG. APPR. ENG. REL. NO. REF.	DATE APR 25, 08 APR 25, 08 APR 25, 08
TITLE		UNIVERSAL SERIAL BUS MINI-B RECEPTACLE, -ROHS COMPLIANT	
DRAWING NO. P-UE25-BEX5-10X		REV. A	
SCALE 3/1		WT. SURF. SHEET 1 OF 7	

THIS DOCUMENT CONTAINS PROPRIETARY INFORMATION AND SUCH INFORMATION MAY NOT BE DISCLOSED TO OTHERS FOR ANY PURPOSE OR USED FOR MANUFACTURING PURPOSES WITHOUT WRITTEN PERMISSION FROM AMPHENOL CANADA CORP.